

Mi Light Detection Sensor
User Manual



Product Overview

The Mi Light Detection Sensor adopts the Zigbee 3.0 wireless communication protocol, and it detects ambient light intensity and records historical data. Based on the change of the ambient light intensity (which can be set as a trigger condition), the sensor can automatically control other smart devices via the control hub, and carry out various intelligent scenarios.

*This product is for indoor use only, and needs to be used along with a device with hub capabilities.

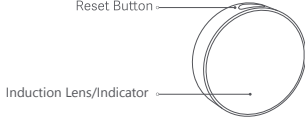

01

Connecting with Mi Home/Xiaomi Home App

This product works with Mi Home/Xiaomi Home app *. Control your device, and interact it and other smart home devices with Mi Home/Xiaomi Home app. Scan the QR code to download and install the app. You will be directed to the connection setup page if the app is installed already. Or search "Mi Home/Xiaomi Home" in the app store to download and install it. Open Mi Home/Xiaomi Home app, tap "+" on the upper right. Select "Mi Light Detection Sensor", and then follow prompts to add your device.

*The app is referred to as Xiaomi Home app in Europe (except for Russia). The name of the app displayed on your device should be taken as the default.

02



Note: The version of the app might have been updated, please follow the instructions based on the current app version.

Installation

Effective Range Test: Press the reset button at the desired location. If the hub beeps, it indicates that the sensor can communicate effectively with the hub.

- Option 1: Place it directly in the desired location.
Option 2: Remove the protective Plm (an

03

additional adhesive sticker can be found inside the box) to stick it at the desired location.
Option 3: Stick the sensor onto a metal surface.
*Make sure the surface is clean and dry.

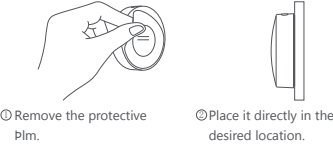

Specifications

Model: GZCGQ01LM
Item Dimensions: 40 × 40 × 12 mm
Wireless Connectivity: Zigbee 3.0
Battery Type: CR2450
Operating Temperature: -10°C to 50°C
Operating Humidity: 0–95% RH, non-condensing

04

Detection Range: 0–83,000 lux
Detection Accuracy: ±2% (Calibrated with an ordinary incandescent light bulb at 2854 K)
±5% (Other visible light sources)
Zigbee Operation Frequency: 2405 MHz–2480 MHz
Zigbee Maximum Output Power < 13 dBm

CE EU Declaration of Conformity
Hereby, Lumi United Technology Co., Ltd., declares that the radio equipment type [Mi Light Detection Sensor, GZCGQ01LM] is in compliance with Directive 2014/53/EU. The full text of the EU declaration of conformity is available at the following internet address: <http://www.mi.com/global/service/support/declaration.html>

05

WEEE Disposal and Recycling Information
All products bearing this symbol are waste electrical and electronic equipment (WEEE as in directive 2012/19/EU) which should not be mixed with unsorted household waste. Instead, you should protect human health and the environment by handing over your waste equipment to a designated collection point for the recycling of waste electrical and electronic equipment, appointed by the government or local authorities. Correct disposal and recycling will help prevent potential negative consequences to the environment and human health. Please contact the installer or local authorities for more information about the location as well as terms and conditions of such collection points.

06

Symbol on the product or on its packaging indicates that this product may not be treated as household waste. Instead it shall be handed over to the applicable collection point for the recycling of electrical and electronic equipment.

07