

# Ninebot KickScooter External Battery User Manual



# 1 Packing List

## Battery Pack



Power on the KickScooter. Press the Power Button to turn on/off the ambient light.

\* E22D, E25D, E45D does not have this feature.

## Rail



## User Manual

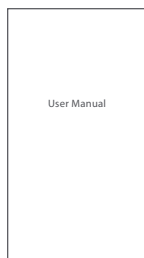

## Accessories



When unboxing your battery pack, please verify that the above items are included in the package. If any components are missing, please contact your dealer/distributor or nearest service center.

# 2 Installing

1. Remove the cover (a), and remove the M3 screws (b) with 2.5 mm hex wrench. Then remove other components (c).

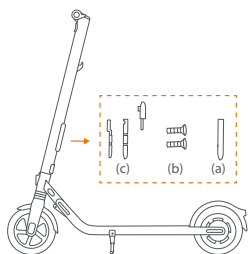

2. Remove the screw (d) with 2 mm hex wrench. Then remove the three screws (e) on the stem with 2.5 mm hex wrench.

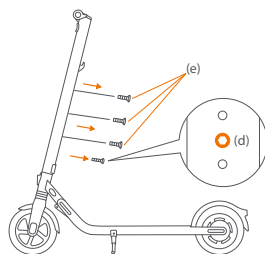

3. Align the rail. Pre-tighten the screws in order with 2.5 mm hex wrench and tighten.

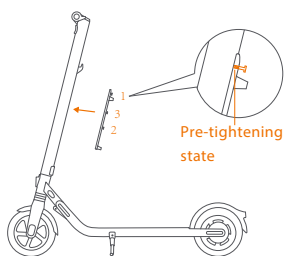

4. Install the external battery on the rail. Fixate the two M4 screws (with 3 mm hex wrench) and the M3 screw (with 2.5 mm hex wrench). Block the screw holes with the rubber stopper when installed.

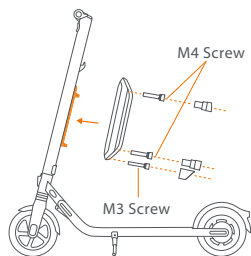

# 3 Charging

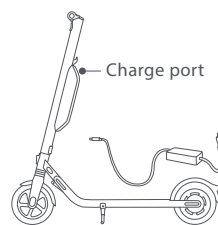

Steps:

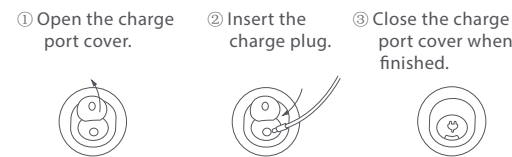

⚠ Do not connect the charger if the charge port or charge cable is wet. Do not charge or use your battery if it is damaged or see trace of water.

Your KickScooter is fully charged when the LED on the charger changes from red (charging) to green (trickle charge). Close the charge port cover when not charging.

# 4 Safety Instructions

1. Battery model NEB1002-H1 is only suitable for the Ninebot KickScooter ES, E22, E45 series models. Battery model NEB1002-U1 is only suitable for the Ninebot KickScooter E25 series. Do not use other models or brands of scooters, otherwise there may be safety risks.
2. Do not store or charge the battery at temperatures outside the stated limits (see Specifications).
3. Do not touch battery contacts. Do not dismantle or puncture the casing. Keep the battery contacts away from metal objects to prevent short circuit.
4. Risk of fire. Do not expose the battery to fire.
5. Do not charge or use your battery if it is damaged or see trace of water.
6. Do not puncture the battery. Do not attempt to disassemble the battery. No user serviceable parts.
7. Completely draining the battery may cause permanent damage to the battery. Charge the battery after each ride and avoid draining the battery completely. Please read the user manual before charging the battery.
8. Do not discard or destroy the battery. Refer your local laws and regulations regarding battery recycling and/or disposal.

# 5 Specifications

Name	Ninebot KickScooter External Battery	
Model	NEB1002-H1	NEB1002-U1
Color	Black	Gray
Nominal Voltage	36 V	36 V
Max. Charging Voltage	42 V	42 V
Nominal Energy	184 Wh	215 Wh
Nominal Capacity	5100 mAh	5960 mAh
Storage Temperature	32—104°F (0—40°C)	
Battery Management System	Over-heating, short circuit, over-current, over-discharge and over-charge protection	
Suitable for Ninebot KickScooter model	ES Series: ES1, ES2, ES2L, ES4 E22 Series: E22, E22D, E22E E45 Series: E45, E45D, E45E	E25 Series: E25, E25A, E25D, E25E

## Comparison Tables

Some of the Ninebot KickScooter parameters would change AFTER the external battery installed.

### Model: NEB1002-H1

Item	Compatible KickScooter Model	Before Installation	After Installation
Typical Range <sup>[1]</sup>	ES1 / ES2 / ES2L	15.5 miles (25 km)	28.0 miles (45 km)
	E22 / E22D / E22E	13.7 miles (22 km)	28.0 miles (45 km)
	E45* / E45D* / E45E* / ES4*	28.0 miles (45 km)	
Max. Slope	ES1 / ES2 / ES2L	10%	15%
	E22 / E22D / E22E	15%	20%
	ES4*	15%	
	E45* / E45D* / E45E*	20%	
Max. Speed <sup>[2]</sup>	E22D / ES2L	12.4 mph (20 km/h)	12.4 mph (20 km/h)
	ES1 / E22 / E22E	12.4 mph (20 km/h)	15.5 mph (25 km/h)
	ES2	15.5 mph (25 km/h)	18.6 mph (30 km/h)
	E45* / ES4*	18.6 mph (30 km/h)	
	E45D*	12.4 mph (20 km/h)	
	E45E*	15.5 mph (25 km/h)	

\* The external battery is included in E45 series scooters.

### Model: NEB1002-U1

Item	Compatible KickScooter Model	Before Installation	After Installation
Typical Range <sup>[1]</sup>	E25 / E25A / E25D / E25E	15.5 miles (25 km)	28.0 miles (45 km)
Max. Slope	E25 / E25A / E25D / E25E	15%	20%
Max. Speed <sup>[2]</sup>	E25D	12.4 mph (20 km/h)	12.4 mph (20 km/h)
	E25E	15.5 mph (25 km/h)	15.5 mph (25 km/h)
	E25	15.5 mph (25 km/h)	18.6 mph (30 km/h)
	E25A	17.4 mph (28 km/h)	18.6 mph (30 km/h)

[1] Typical Range: tested while riding under full power, 165 lbs (75 kg) load, 77°F (25°C), 60% of max. speed on average on pavement.

\* Some of the factors that affect range include: speed, number of starts and stops, ambient temperature, etc.

[2] In accordance with laws and regulations in different countries, max. speed may vary.

## 6 After-sales Service

For aftersales service information, please visit our official website.

The Americas: [store.segway.com](http://store.segway.com)

The Europe: [www.segway.com](http://www.segway.com) website

## 7 LIABILITY DISCLAIMER AND LIMITATION

NINEBOT AND OTHER NINEBOT PARTIES DO NOT ASSUME, OR AUTHORIZE ANYONE TO ASSUME ON ITS BEHALF, ANY OTHER OBLIGATION OR LIABILITY IN CONNECTION WITH THE PRODUCT, ITS COMPONENT PARTS, ACCESSORIES, OR SERVICE REPAIR.

NINEBOT AND OTHER NINEBOT PARTIES ARE NOT RESPONSIBLE FOR ANY LOSS OF USE OF THE PRODUCT, ITS COMPONENT PARTS, ACCESSORIES, OR FOR ANY INCONVENIENCE OR OTHER LOSS OR DAMAGE WHICH MIGHT BE CAUSED FROM ANY DEFECT IN A PRODUCT, ITS COMPONENT PARTS, ACCESSORIES, SERVICE REPAIR, OR FOR ANY OTHER INCIDENTAL OR CONSEQUENTIAL DAMAGES THE PURCHASER MAY HAVE AS A RESULT OF ANY DEFECT IN A PRODUCT, ITS COMPONENT PARTS, ACCESSORIES, OR SERVICE REPAIR. SOME COUNTRIES/STATES DO NOT ALLOW THE EXCLUSION OR LIMITATION OF INCIDENTAL OR CONSEQUENTIAL DAMAGES, SO THE ABOVE LIMITATION OR EXCLUSION MAY NOT APPLY TO YOU.

IN NO EVENT NINEBOT OR OTHER NINEBOT PARTIES' TOTAL AND AGGREGATE LIABILITIES FOR ALL CLAIMS UNDER ANY AND ALL APPLICABLE LAW OR THEORY, JOINTLY OR SEVERALLY, ARISING OUT OF OR RELATED TO THE PURCHASE OF THE PRODUCT, BREACH OF CONTRACT, TORT (INCLUDING NEGLIGENCE) OR OTHERWISE EXCEEDS THE DUTY TO REPAIR OR REPLACE ANY DEFECTIVE PRODUCT, FURTHER SUBJECT TO NINEBOT'S SOLE AND EXCLUSIVE DISCRETION. IN NO EVENT SHALL NINEBOT OR OTHER NINEBOT PARTIES BE LIABLE TO ANY PERSON FOR CONSEQUENTIAL, INDIRECT, INCIDENTAL, SPECIAL, EXEMPLARY, PUNITIVE OR ENHANCED DAMAGES ARISING OUT OF, OR RELATING TO, AND/OR IN CONNECTION WITH THE PURCHASE OF THE PRODUCT, ANY BREACH OF THIS AGREEMENT OR MANUFACTURER'S DUTIES REGARDLESS OF (A) WHETHER SUCH DAMAGES WERE FORESEEABLE, (B) WHETHER OR NOT NINEBOT WERE ADVISED OF THE POSSIBILITY OF SUCH DAMAGES, AND (C) THE LEGAL OR EQUITABLE THEORY (CONTRACT, TORT OR OTHERWISE) UPON WHICH THE CLAIM IS BASED, UNLESS SUCH LIMITATIONS AND EXCLUSIONS ARE PROHIBITED BY APPLICABLE LAW. THE FOREGOING LIMITATIONS OR EXCLUSIONS APPLY EVEN IF AN AGGRIEVED CUSTOMER OR ANY OTHER PERSON'S (WHO MIGHT HAVE RIGHT OR CLAIM UNDER THIS AGREEMENT BY OPERATION OF LAW OR EQUITY) REMEDIES UNDER THIS AGREEMENT FAIL OF THEIR ESSENTIAL PURPOSE. IN THE EVENT SOME COUNTRIES/STATES DO NOT ALLOW THE EXCLUSION OR LIMITATION OF CERTAIN OR ALL OF THE FOREGOING DAMAGES, SO TO THE EXTENT THAT SUCH LIMITATIONS OR EXCLUSIONS ARE NOT ALLOWED BY LAW, THEY MAY NOT APPLY TO YOU. SOME COUNTRIES/STATES DO NOT ALLOW THE EXCLUSION OR LIMITATION OF INCIDENTAL OR CONSEQUENTIAL DAMAGES, SO THE ABOVE LIMITATION OR EXCLUSION MAY NOT APPLY TO YOU.