

This diagram shows the exploded view of the combination lock assembly. The components are arranged as follows:

- Bracket × 1**: A metal bracket with a mounting hole and a slot for the lock cylinder.
- Combination Lock × 1**: A large, coiled metal lock cylinder with a dial and a handle.
- Gasket × 1**: A small, circular O-ring.
- Screw × 1**: A single screw with a cross-shaped head.
- Nut × 1**: A hexagonal nut.

Press the red button on the bracket, and unplug the combination lock.

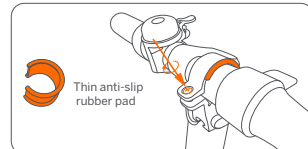

*Note: The bracket contains two anti-slip rubber pads, please choose to use one or two according to your vehicle type.

① Align the numbers to unlock. ② Rotate the dial clockwise to the end.

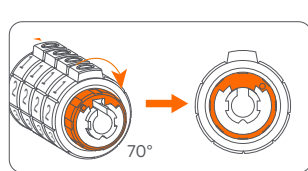

A diagram of a device with a 3x5 grid of buttons. The buttons are numbered 0 through 5. The top row contains buttons 0, 1, 2, 3. The middle row contains buttons 1, 2, 3, 4. The bottom row contains buttons 2, 3, 4, 5. An orange arrow points right from the button labeled 1 in the middle row. Another orange arrow points left from the button labeled 3 in the top row. A checkmark icon in a circle is located to the right of the grid.

Ninebot Password Lock for KickScooters User Manual

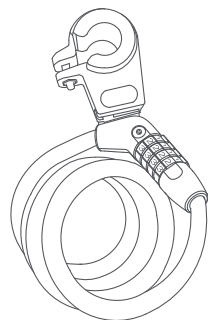

Please scramble the dials after locking your scooter.

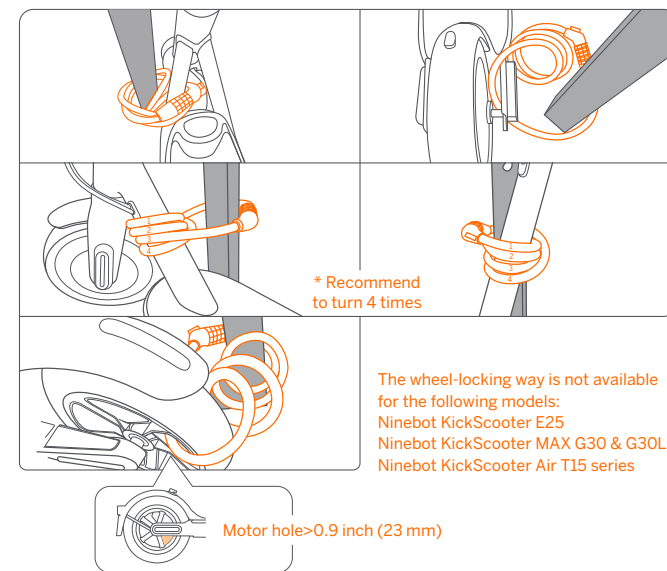

Ninebot is the trademark of Ninebot (Beijing) Tech. Co., Ltd; The respective owners reserve the rights of their trademarks referred to in this manual. We have attempted to include description and instructions for all the functions of the Ninebot Password Lock for Kick Scooters at the time of printing. However, due to constant improvement of product features and changes of design, the product may differ slightly from the one shown in this document.

6 Specifications

Product name	Ninebot Password Lock for Kick Scooters
Model	PR0201
Suitable for	Ninebot Kick Scooters, Ninebot eKick Scooters, Mi Electric Scooters.
Net Weight	Approx. 0.6 lbs (255 g)
Material	Steel cables, PVC, PP, ABS, Zinc alloy
Lock body (diameter × length)	Approx. 0.3 × 47.2 inch (10 mm × 1.2 m)
Lock cap (diameter × length)	Approx. 0.8 × 3.8 inch (21 × 96 mm)
Dial	Four cams with number on the surface, from 0 to 8.
Initial password	0000
Method of changing password	Rotate the dial

Warranty

The Americas: <https://store.segway.com/warranty-information>
The Europe: <https://www.segway.com/international>
The APAC: <https://ap-en.segway.com/download.html>

Customer Service

For product issues, please contact Segway online customer service in your region or send your requests via e-mail, Segway's support personnel are available to assist you.

Segway Online Service Link

The Americas: <https://segway-ninebot.force.com/hc/s/contactsupport>
The Europe: <https://www.segway.com/international>
The APAC: <https://ap-en.segway.com/service-locations.html>

Segway Customer Support E-mail Address

The Americas: technicalsupport@segway.com
The Europe: service@segway.eu.com
The APAC: service@ninebot.com