



D12 User Manual

SHENZHEN FIIDO TECHNOLOGY DEVELOPMENT CO.,LTD

NO.142 Fiido Industrial Park,Futong Rd. Yuanshan St. Longgang District, Shenzhen, China

<https://www.fiido.com> email: support@fiido.com



Made in China

Fiido Electric Bicycle Catalog

I.Important Note

II.Bike Diagrams

III.How to adjust the saddle height

IV.Unfolding Instructions

V.Folding Instructions

VI.Specifications

VII.Daily maintenance and basic trouble shooting

E-Scooter and E-Bike laws differ by State - check your local laws and only ride in legally permitted areas.
Use helmets, protective gear and always ride responsibly.

Riding Safety

As with other sports, bicycling involves risk of personal injury and damage of the bicycle. By choosing to ride a bicycle, you assume the responsibility for that risk, so you need to know - and to practice - the rules of safe and responsible riding and of proper use and maintenance. Proper use and maintenance of your bicycle reduces risk of injury.

Because it is impossible to anticipate every situation or condition which can occur while riding, this Manual makes no representation about the safe use of the bicycle under all conditions. There are risks associated with the use of any bicycle which cannot be predicted or avoided, and which are the sole responsibility of the rider. If you have any questions or do not understand something, take responsibility for your safety and consult with the bike shop or the bicycle's manufacturer. It is important for rider to read carefully all instructions below before your first ride.

I. Important Note

This manual includes important safety performance and service information. Please make sure to read the following warnings before using our products for the first time.

- a) If you lend your e-bike to other people, please confirm that he/she has read this manual to decrease the risk of accident.
- b) Please wear a suitable and safe helmet before riding, please wear clothes with fluorescent and reflective stripes when riding at night. Follow the traffic rules and don't exceed the speed limits, which may cause accidents.
- c) Don't touch or use metal to touch the charging port on the bike, otherwise it will cause a short circuit.
- d) Following actions will cause huge power drops and reduce the riding distance:
 - 1. Starting the bike by using the throttle.
 - 2. Frequent braking.
 - 3. Riding against the wind.
 - 4. Overloading.
 - 5. Insufficient tire pressure.
- e) To extend the riding range :
 - 1. Please use assist mode.
 - 2. Brake only when necessary for safety, and don't use the throttle to start the bike.
 - 3. Don't overload.
 - 4. Before riding, please check the tire pressure and supply enough pressure.
- f) When charging the e-bike, please make sure that there is nothing inside of the charging port. Connect the charger to the bike first and then to the AC power source to avoid sparking.
- g) Please consult your insurance company or insurance broker on the insurance coverage of riding an electric bike.
- h) Generally, people must be 16 years old to ride an e-bike or three-wheel electric bikes. Please refer to local laws and regulations when using this product in your country.
- i) Bicycles are vehicles with certain risks, brake the rear wheel first, and then the front wheel in emergency braking, especially when the cycling speed is too high, you may fall over if you use the front brake suddenly. Please ride carefully.

Safety Guidelines

1. Always ride with both hands on the handle.
2. Do not park in building doors, evacuation staircases, walkways, and safety exits.
3. Do not charge inside residential building and park
4. Stay away from combustible when charging.
5. Please charge according to suggested time, do not charge for too long.
6. Use and store the batteries correct; batteries should never be disassembled.
7. Read all warning terms before riding or charging, only use original charger.
8. When adjusting the saddle position, do not exceed the safety line on the supporting

II. Bike Diagrams

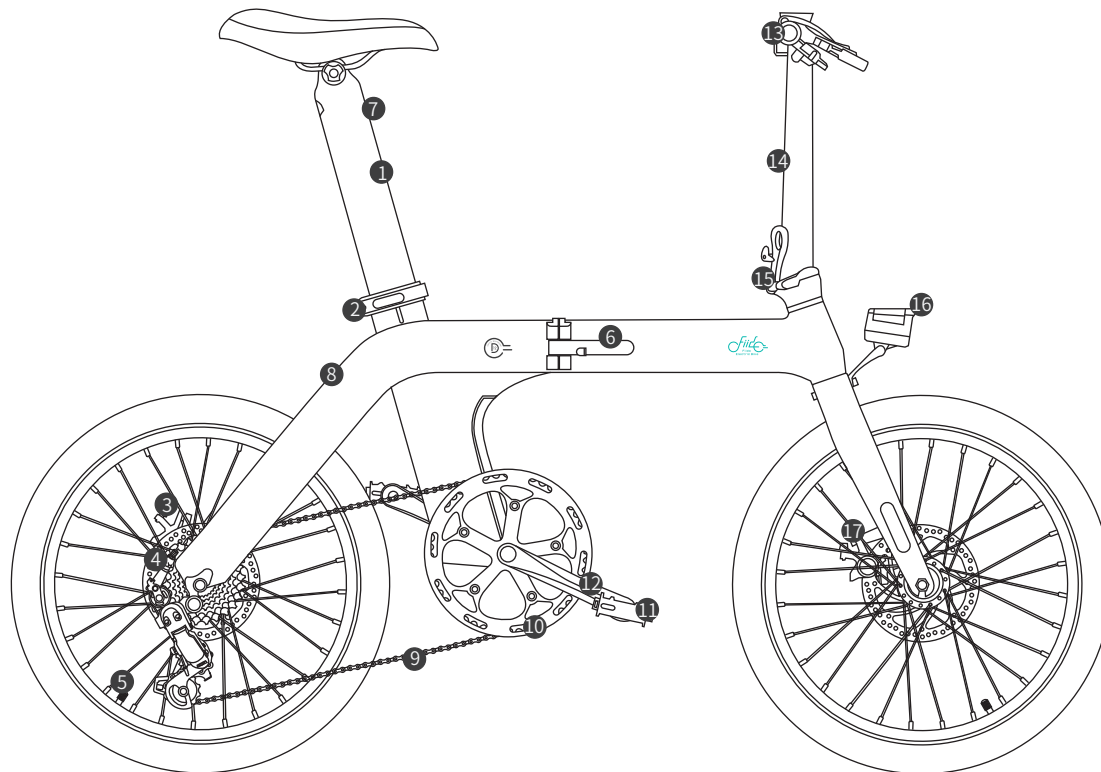

1.Removable battery
2.Quick release
3.Brake disc
4.Hub motor

5.Valve
6.Folding system
7.Charge port
8.Controller box

9.Chain
10.Chain wheel
11.Pedal
12.Crank

13.Handle bar
14.Stem
15.Folding system
16.Headlight

17.Brake disc

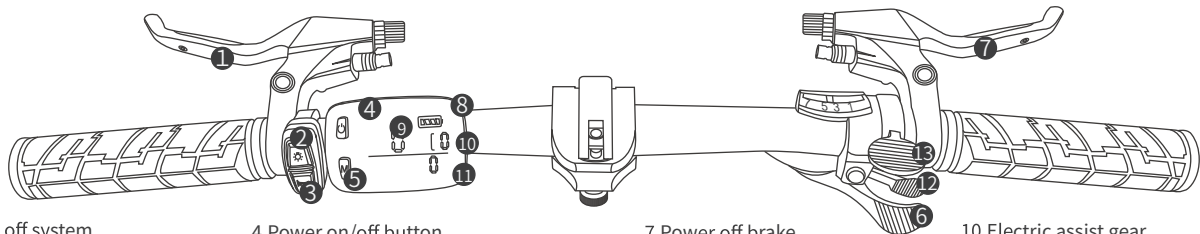

1.Brake power off system
(Left brake handle for rear brake)

2.Light button
(Click once power on/off)

3.Horn button
(Click the button once to signal the whistle)

4.Power on/off button
(Long press turn on/off electric power mode)

5.Power adjustment
(Click once to shift gears, a total of 3 gears)

6.Thumb shifter
(Turn the handle outward to reduce the gear)

7.Power off brake
(Right brake handle for front brake)

8.Battery level
(Display remaining battery)

9.Speed
(Display current speed)

10.Electric assist gear
(Display power gear number)

11.Odometer
(Display the current mileage, long press M to display the total mileage)

12.Thumb shifter
(Turn the handle outward to increase the gear)

13.Electric-assist throttle
(Provide electric assistant)

(Note: The bike will automatically shut down when it is stationary if not used within 10 minutes.)

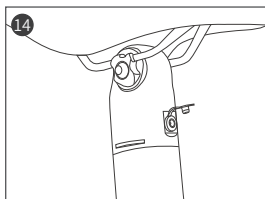

14.Battery charging port
(located below the saddle)

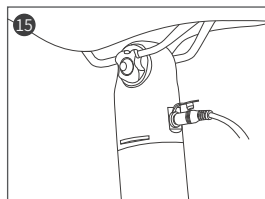

15.Insert the charger port
(Standard charger)

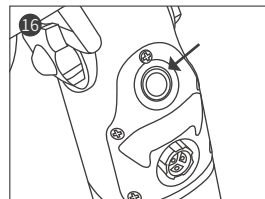

16.On/Off button
(Once it's on, the tail light will turn on as well.)

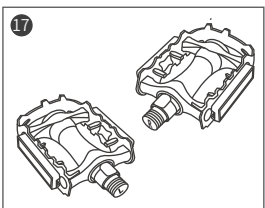

17.Pedal

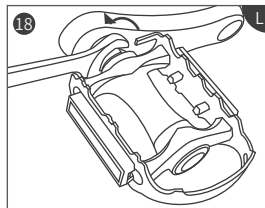

18.Left

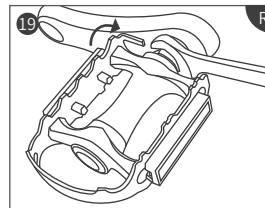

19.Right

Use a 15mm spanner to screw the pedal spindle into the thread hole and tighten it in the direction of the arrow (left counterclockwise, right and clockwise, as shown).

(Note: When installing the pedal, be aware of the left and right, align the installation horizontally to prevent the pedal from slipping out of the crank.)

III. How to adjust the saddle height

Battery seat tube:

Open the seat tube quick release(Figure 2), pull the battery seat tube out of the frame, and adjust the height of the battery seat tube up and down according to your needs.

When you adjust the height of the battery seat tube, then buckle the seat tube quick release.

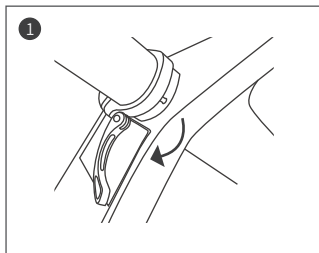

1.Open the seat tube quick release

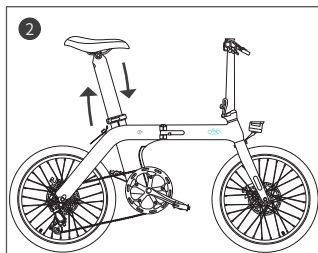

2.Adjust to the right seat height for you

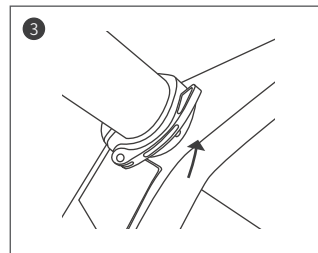

3.Adjust the height of the seat tube,
and finally buckle the seat tube for quick release

IV. Unfolding Instructions

1. Unfold the D12 bike frame to straightened position and tighten the frame folding handle and safety clasp.
2. Unfold the handle bar tube to the upper position, lock the raised tube into position, and tighten the safety clasp. Adjust the T-handle bar into riding position.
3. To insert the seatpost clamp into position, first open the seatpost clamp located on the bike frame, then insert the seatpost and adjust the tube into position (note the marked lines on the seatpost). Adjust the bike seat height until you find the perfect riding position, then tighten the seatpost clamp to lock into position.

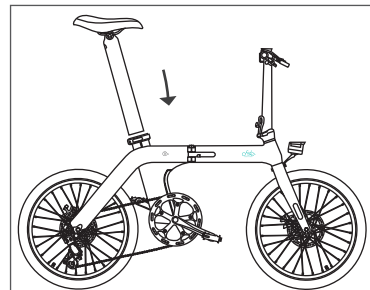
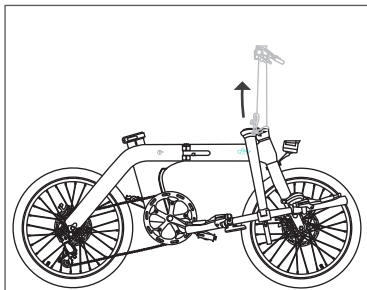
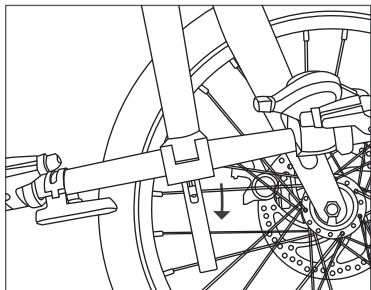

4. For your safety, double check the following items are in position before riding: Frame/seat/handle tube locking positions, brake system function, tires inflated, battery charge, and your safety gear.

5. Enjoy your D12 and have a fun ride on the world's best electric bike.

Note: Both the Rise and the Seat Tube are marked with a safe (MAX or MIN). For safety reasons, please use them in a safe range.

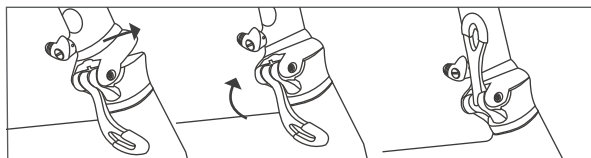

steering tube lock and unlock

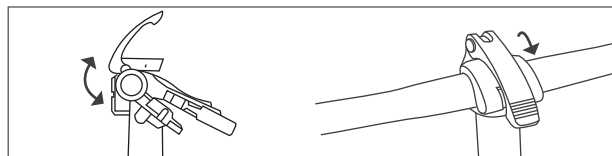

adjusting the handle bar

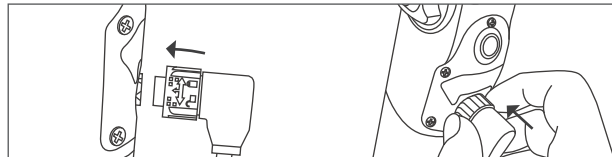
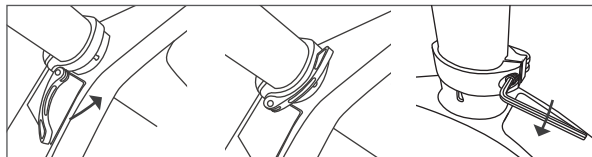

insert to charge

V. Folding Instructions

Step 1. Open up the lock at the base of the seatpost, then gently lower the seat to the bottom, and then close the clamp to lock it in position.

Step 2. Open up the lock at the base of the steering tube, then gently fold down the tube and handle bar.

Step 3. Open up the lock at in the centre of the bike frame, and then fold the D12 in half.

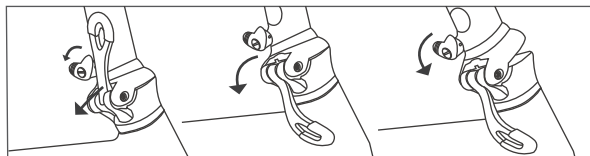
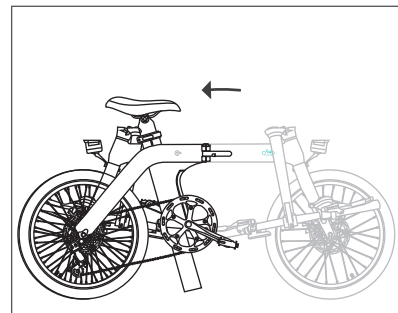
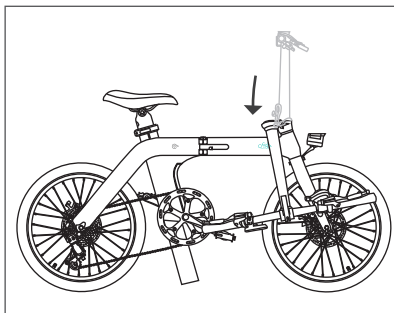
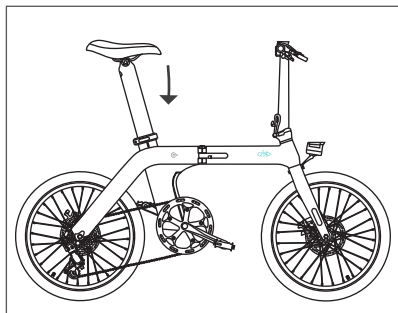

locked

opened

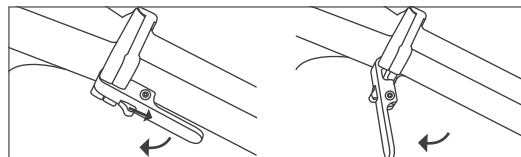

locked

opened

VI. Specifications

Name	Specification
Electric Bike System	FIIDO System
Power Assist System	3 Gears Assist
Max Load weight	120kg
Maximum power assist speed	25km/h
Maximum Range	Power assisted model up to 80-100KM
Battery	High quality Lithium-ion 48V 11.6Ah
Battery adaptation	DC 42V 2A
Recharge Time	7 hours
Display	LCD Display
Drive Type	Rear Drive
Frame Material	Aluminum Alloy
Front Brake	Mechanical Disc Brakes
Brake Type	Mechanical Disc Brakes
Chainset	Prowheel Steel 52 Tooth
Gears	Shimano 7-speed gear
Chain	KMC Z7
Rear Brake	Mechanical Disc Brakes
Rear Hub/Rated Power	XiongDa Motor/250W
Rims	Alloy
Wheel Size	20"
Tyre Size	20" × 1.75 inch
Tyres	Cheng Shin Tire
Net Weight	17.5kg(with battery)
Unfold size	148cm × 57cm × 110cm
Folding size	80cm x 74cm x 40cm

* The above data allow for 5% manufacturing tolerances.

* After receiving the goods, there may be some differences between individual accessories and display drawings, which are different due to the different batches, and do not affect the use.

VII. Daily maintenance and basic trouble shooting

Brake abnormal sound or wheel rotation resistance	1.Check whether the end of the brake cable is stuck.
	2.Slight friction can be adjusted by fine-tuning the end of the line
	3.Adjust the brakes to ensure that the brake pad and brake disc clearance is balanced
	4.If the brake pads are worn, replace brake pads.
Seat tube slide down	1.The set screw of the seat tube clamp is not tightened. Adjust the set screw.
	2.Check whether the anti-skid bushing inside the seat tube clamp is damaged ,if it's broken, replace the anti-skid bushing.
Difficulty in folding bicycle	1.Check whether the spring at the folding joint is out of shape, or the spring is pulled out without return, if the spring is damaged ,it needs to be replaced.
	2.Dry folding joints cause folding difficulties, can use lubricating oil to lubricate the joints.
Handlebars are not straight	1.Loosen the standpipe fixing screw, readjust the handlebar, and then tighten the standpipe fixing screw.
Saddle loose (slide up and down)	1.Check whether the saddle fixing screw is tightened. Retighten the saddle bottom fixing screw with the hex tool
	2.The loose fixing screw of the saddle slides up and down, resulting in the sliding teeth of the rack of the seat tube clamp code.It need to replace the seat tube clamp code.
Chain often falls off	1.Check whether the chainset is deformed and if the chainset is deformed ,it need to replace the chainset
	2.Check whether the rear derailleur is loose,relck the rear derailleur and then lock the screw.
Fault code	
E001	Controller fault
E002	Display communication fault
E003	Motor hall fault
E004	Handlebar fault
E005	Motor fault
E006	Motor phase fault

* When the battery is used up, it should be fully charged in time. The green light on the charger indicates full charge.Long-term underpowered storage will affect the performance of the battery.

* When cross the pool, water section, please pay attention to the wading height is not higher than the hub, prevent motor damage due to water inflow.Do not use high pressure water gun to clean, so as not to damage the electronic components and wiring due to humidity.

* Add some lubricating oil to the chain and flywheel of the bike to avoid wading and rusting

* It is best to charge the battery in an ventilated, dry place.Direct sunlight or rain can have a bad effect on the performance of batteries and chargers.When charging, the battery and charger should be away from other sources of heat.

* Connect the battery before charging, and then plug it into the electric supply .After charging, pull out the electricity first, and then pull out the battery end.If do not follow the steps, it will cause a fire when connecting the battery end.